

Box Contents

- 1 x Long Throw Lock
- 1 x Keep
- 1 x Escutcheon
- All Fittings & 5 Keys
- 1 x 26mm Drill Bit

Recommended Tools

Power Drill, Tape Measure, Pencil or Marking Tool, 2mm Wood Drill Bit, 3mm Wood Drill Bit, Small Flat Head Screwdriver.

Safety Notice

Always use suitable protection when operating power tools. Gloves, eye protection and safety footwear are recommended when using tools. This product should be installed by a suitably qualified professional.

General advice

This lock should be fitted after the door or gate has been hung and correctly adjusted. The body of the lock should be fitted on the inside (secure side) of the door or gate with just the barrel showing on the outside.

Correct Fitting Method

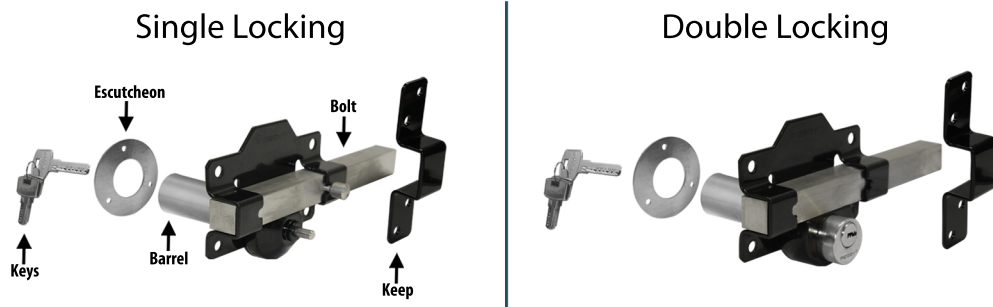

Also Available

Long Throw Lock Handles

Product Code: No.1125



Black

Polished
Brass

Polished
Chrome

How to fit this product

1. Mark the centre of the barrel position on the door/gate, ensuring the position is suitable for fitting on both sides of the door/gate (minimum 50mm from the edge of the door/gate). Note: The body of the lock should be a minimum 5mm from the edge of the door/gate, ensuring the lock reaches across. The holes in the bar should face down.
2. Drill a 26mm hole using the Auger/Flat wood drill bit supplied with the lock.
3. Insert the lock and level up. Mark the holes for fixing the lock to the door/gate.
4. Remove the lock and drill pilot holes using a 3mm wood drill bit.
5. Replace the lock and fix to the gate/door using the screws provided. Note: Test the lock at this point, if the surface is not even the screw may need loosening or packing may be required for optimum performance.
6. Fit the escutcheon or the optional handle over the barrel on the other side of the gate and mark the holes for fixing the plate to the door/gate.
7. Remove the escutcheon/handle. If fitting the escutcheon, drill pilot holes using a 2mm wood drill bit. If fitting the optional handle, drill pilot holes using a 3mm wood drill bit.
8. Fix the escutcheon or handle to the gate/door using the screws provided.
9. Turn the lock into the 'locked' position and place the keep over the bolt, lining it up straight with the edge of the post or frame. Mark the holes for fixing the keep.
10. Remove the keep and drill pilot holes using a 3mm wood drill bit.
11. Fix the keep to the post/frame using the screws provided.

Maintenance advice

This locking mechanism is made from high quality stainless steel and brass components. To ensure a long life from the moving components, regularly oil between the bolt and the back plate above the barrel.